

WATERSCOPE REGISTRATION

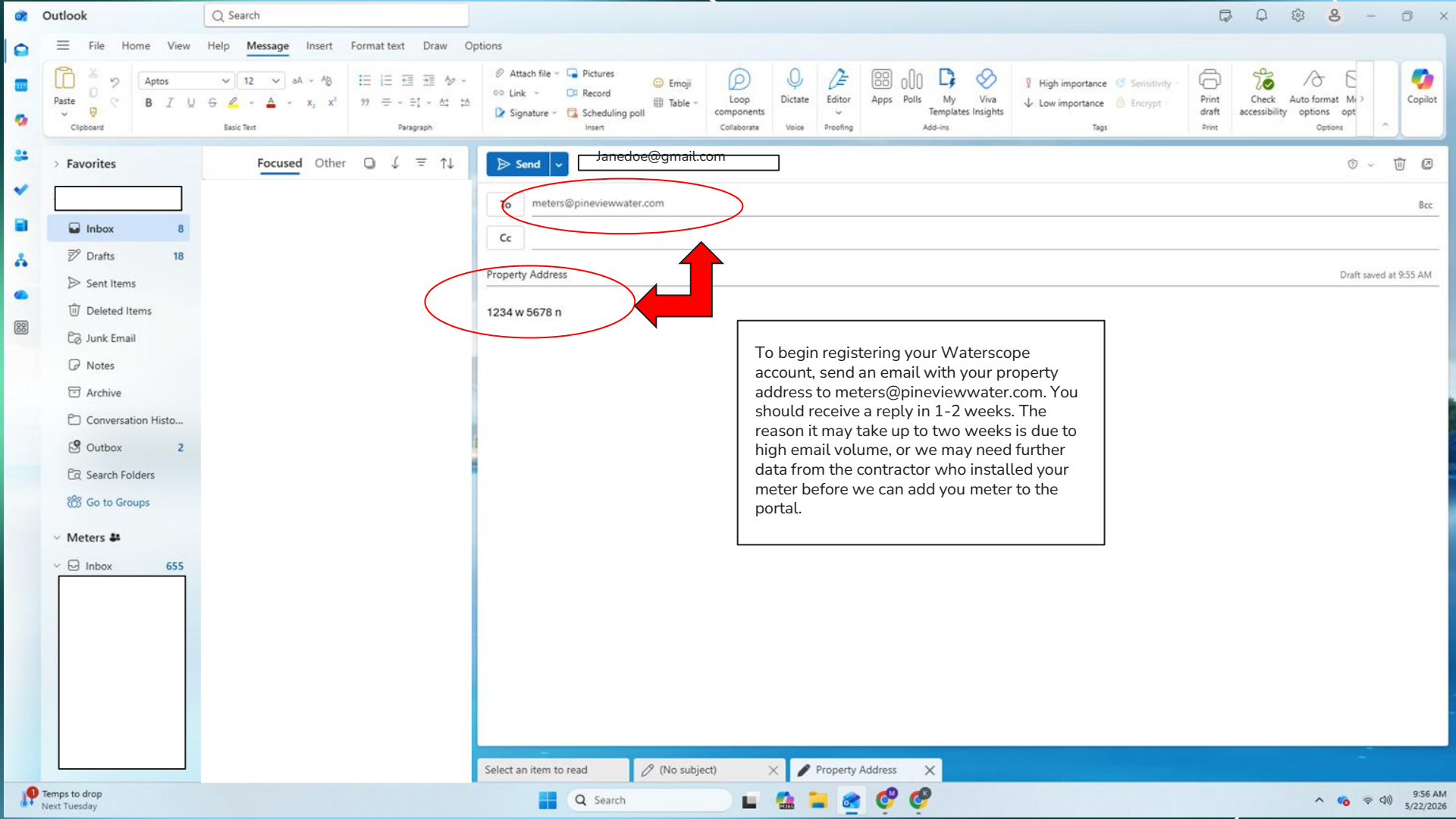



Send Janedoe@gmail.com

To meters@pineviewwater.com

Cc

Property Address

1234 w 5678 n

To begin registering your Waterscope account, send an email with your property address to meters@pineviewwater.com. You should receive a reply in 1-2 weeks. The reason it may take up to two weeks is due to high email volume, or we may need further data from the contractor who installed your meter before we can add you meter to the portal.

To _____ Bcc

Cc _____

Meter Portal Draft saved at 10:20 AM

Thank you for contacting Pineview Water Systems to access the meter portal. Below is the link you will use, as well as the VN ID and Account Id.

Once you click on the link, click on Register. Type in your VN ID and Account ID. It will then ask if you want to add another meter. If you only have one meter installed on your property, select no. If you have additional meters on your property, please contact 801-622-4353 so we can provide you all VN ID's. To continue with registration, type in your email and click submit. You will receive an email from WaterScope to verify your email. Once verified, you will receive a second email with your username and a temporary password. We recommend you change the password once logged in.

Once you are logged into your meter portal account, you will be able to view your usage and set up notifications.

At this time, you will still be billed through your property taxes, not by usage. If that changes in the future, you will be notified.

If you have any questions about your meter or the portal, you may email us at meters@pineviewwater.com or call 801-622-4353.

<https://waterscope.us/Home/Main>

VN ID: 123456
Account ID: A78910

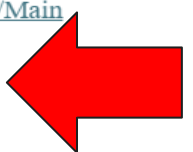

Once you have gotten a reply, your VN ID and Account ID will be at the bottom of the email we reply with. You may need to scroll down to the bottom of the email to view these items. These are the two items you will need to register at waterscope.us for your Waterscope account.

Thank you.
Kalli Nelson
Meter Portal Technician
801-622-4353

METRON WaterScope®

Enter User Name

Continue

[Register](#)



Want Metron's water experts to monitor your water for you? Now you can, with our WaterMasters™ service! [Learn more](#)

Click on the register link

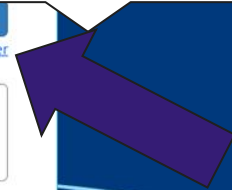

VN ID

ACCOUNT ID



METRON WaterScope®

Register **Consumer**

3263725

2100002

Submit Cancel

[Privacy Policy](#)



Consumer Registration

Do you want to add another meter?

Note - Please click No if this is the only meter you are registering at this time.

Yes No

No if you only have one meter

Yes, only if you have more than one meter

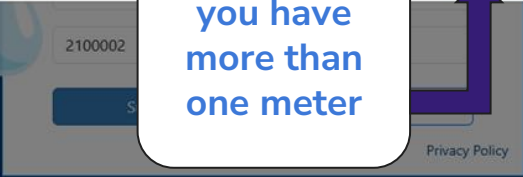



Register **Consumer**

3263725

2100002

meters@pineviewwater.com

I'm not a robot



Submit

Cancel

[Privacy Policy](#)

Check
mark
goes here

username is full
email

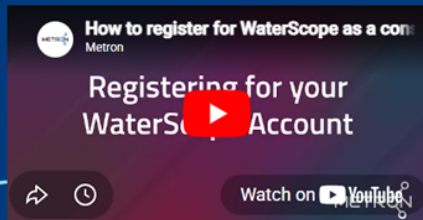

Hello meters,

Please authenticate your email: [Click here to authenticate](#)

We request you to change your password after you first Login for Security reasons.

This link will get expired in 24 hr.

Thanks,

WaterScope

[Click here to login into WaterScope](#)

Note: This email is sent through an automated service. Please do not reply to this email. If you have any concerns, please contact your Utility person in-charge for further support.



**Click to
authenticate
email**

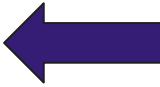

Hello **meters@pineviewwater.com**

You have been successfully registered on WaterScope.

Please see below your WaterScope Account details:

Username: **meters@pineviewwater.com**

Password: kifk4798KI@

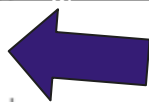

Temporary
password

We recommend you to change your password after your first login for security reasons.
This can be accomplished by clicking on your username on the upper right of the Portal.

Thanks,
WaterScope

[Click here to login into WaterScope](#)

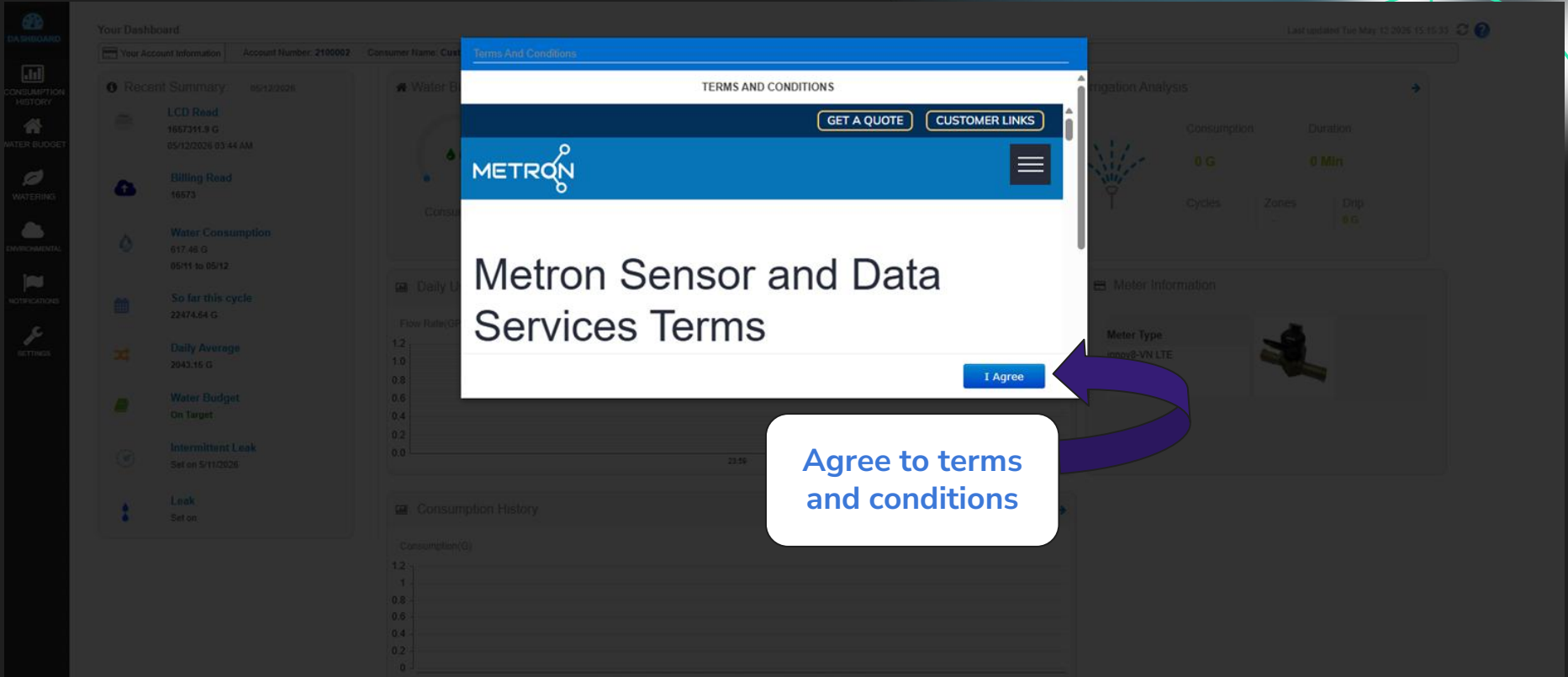

Terms And Conditions

TERMS AND CONDITIONS

GET A QUOTE CUSTOMER LINKS

METRON

Metron Sensor and Data Services Terms

I Agree

Agree to terms and conditions

- DASHBOARD
- CONSUMPTION HISTORY
- WATER BUDGET
- WATERING
- ENVIRONMENTAL
- WORKING TOOLS
- SETTINGS

Your Dashboard

Account Number: 2100002 Consumer Name: Cust

Recent Summary 05/12/2026

- LCD Read**
1657311.9 G
05/12/2026 03:44 AM
- Billing Read**
16573
- Water Consumption**
617.46 G
05/11 to 05/12
- So far this cycle**
22474.64 G
- Daily Average**
2943.16 G
- Water Budget**
On Target
- Intermittent Leak**
Set on 5/11/2026
- Leak**
Set on

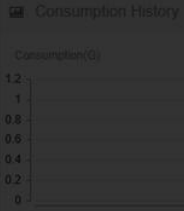

Usage Analysis

Consumption	Duration
0 G	0 Min
Cycles	Zones
	Drip
	0.0

Meter Information

Meter Type
mcy2-VN LTE



DASHBOARD



CONSUMPTION HISTORY



WATER BUDGET



WATERING



ENVIRONMENTAL



NOTIFICATIONS



SETTINGS

Your Dashboard

Your Account Information Account Number: 2100002 Consumer Name: Customer Address: 1... N ID: 3263725

Recent Summary: 05/12/2026

- LCD Read**
1657311.9 G
05/12/2026 03:44 AM
- Billing Read**
16573
- Water Consumption**
617.46 G
05/11 to 05/12
- So far this cycle**
22474.64 G
- Daily Average**
2043.15 G
- Water Budget**
On Target
- Intermittent Leak**
Set on 5/11/2026
- Leak**
Set on

Water Budget

Consumption: 0%
1 / 20 Days

Usage Analysis

Indoor
Irrigation
Leak

Irrigation

Consumption: 0 G
Duration: 0 Min

Cycles: -
Zones: -
Drip: 0 G

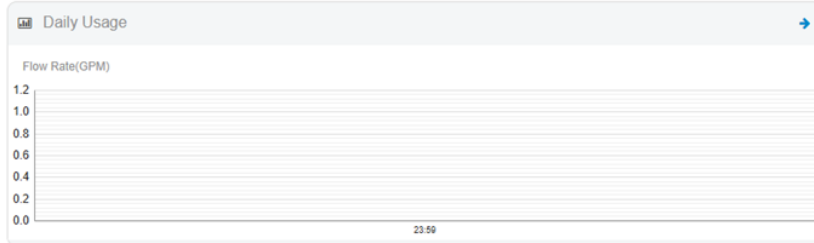

Meter Information

Meter Type
innov8-VN LTE
Metron 1"

Click on email and manage

Manage

Log Out

- DASHBOARD
- CONSUMPTION HISTORY
- WATER BUDGET
- WATERING
- ENVIRONMENTAL
- NOTIFICATIONS
- SETTINGS

You're logged in as meter.aide@pineviewwater.com.

Change Password

Old Password

Next

Enter password you logged in with

DASHBOARD

CONSUMPTION HISTORY

WATER BUDGET

WATERING

ENVIRONMENTAL

NOTIFICATIONS

SETTINGS

You're logged in as **meters@pineviewwater.com**

Change Password

OTP

042698

Next

Otp is sent to **meters@pineviewwater.com**



OTP will be emailed to you

New Password



Confirm Password



Set Password

**New password goes
here
Set password**



Thank you

Contact our team

meters@pineviewwater.com